



Office of General Services

DESIGN & CONSTRUCTION GROUP
THE GOVERNOR NELSON A. ROCKEFELLER
EMPIRE STATE PLAZA
ALBANY, NY 12242

ADDENDUM NO. 2 TO PROJECT NO. 46218

CONSTRUCTION, HVAC, PLUMBING AND ELECTRICAL WORK
PROVIDE IMAGING BAY, BUILDING 35
NATHAN KLINE RESEARCH INSTITUTE
140 OLD ORANGEBURG RD
ORANGEBURG, NY

November 14, 2025

NOTE: This Addendum forms a part of the Contract Documents. Insert it in the Project Manual. Acknowledge receipt of this Addendum in the space provided on the Bid Form.

ELECTRICAL WORK DRAWINGS

1. Revised Drawings:
 - a. Drawings No. FA-000 through FA-300, noted "11/11/2025 REVISED DRAWING" accompanies this Addendum and supersedes the same numbered originally issued drawings.

END OF ADDENDUM

Brady Sherlock, P.E.
Director, Division of Design
Design & Construction

FIRE ALARM SYMBOL LIST

(NOT ALL SYMBOLS ARE USED ON THIS PROJECT)

CONTROL UNITS (PANELS) SYMBOLS

	FIRE ALARM CONTROL PANEL
	FIRE ALARM DATA GATHERING PANEL
	FIRE ALARM TRANSDUCER # = TRANSDUCER NUMBER
	FIRE ALARM ANNUNCIATOR
	NOTIFICATION CIRCUIT POWER BOOSTER PANEL
	FIRE ALARM TERMINAL CABINET
	BATTERY CABINET
	VOICE EVACUATION CONTROL UNIT
	REMOTE VOICE EVACUATION MICROPHONE
	GRAPHIC ANNUNCIATOR PANEL
	UNINTERRUPTIBLE POWER SUPPLY
	CRT
	PRINTER
	FIRE ALARM VESDA SYSTEM PANEL
	FIRE SUPPRESSION CONTROL PANEL, 'XX' DENOTES SUPPRESSION TYPE: PA = PRE-ACTION HL = HALON CA = CLEAN AGENT GAS
	FIRE SUPPRESSION CONTROL UNIT, 'XX' DENOTES SUPPRESSION TYPE: PA = PRE-ACTION HL = HALON CA = CLEAN AGENT GAS
	AMPLIFIER RACK
	AUTONOMOUS CONTROL UNIT
	ELEVATOR STATUS/RECALL
	DIGITAL ALARM COMMUNICATOR TRANSMITTER
	POST-FIRE SMOKE PURGE PANEL
	SPRINKLER ALARM PANEL
	FIREFIGHTER'S SMOKE CONTROL PANEL

NOTIFICATION APPLIANCES SYMBOLS

	NOTIFICATION APPLIANCE SUBSCRIPTS ('XX') WP = WEATHERPROOF WG = WIRE GUARD H = HIGH AUDIBLE SETTING L = LOW AUDIBLE SETTING C = CEILING MOUNT nW = WATTAGE SETTING (n = SPEAKER TAP)
	HORN ONLY C = CEILING MOUNT
	SPEAKER ONLY C = CEILING MOUNT
	BELL - SINGLE STROKE
	BELL - TROUBLE
	GONG
	VISIBLE ONLY (STROBE) - WALL MOUNT CD = CANDELA RATING/SETTING
	VISIBLE ONLY (STROBE) - CEILING MOUNT CD = CANDELA RATING/SETTING
	COMBINATION HORN/VISIBLE CD = CANDELA RATING/SETTING C = CEILING MOUNT
	COMBINATION SPEAKER/VISIBLE CD = CANDELA RATING/SETTING C = CEILING MOUNT
	REMOTE INDICATOR - WALL MOUNT
	REMOTE ALARM INDICATING AND TEST SWITCH
	REMOTE INDICATOR - CEILING MOUNT

RELATED EQUIPMENT

	DOOR HOLDER
	DOOR CLOSER
	INTEGRATED SMOKE SENSOR AND DOOR CLOSER
	END OF LINE RESISTOR
	FIRE SERVICE OR EMERGENCY PHONE STATION STATION, 'X' DENOTES TYPE: J = JACK H = HANDSET A = ACCESSIBLE
	JUNCTION BOX

SIGNAL INITIATING DEVICES & ACTIVATION SWITCHES SYMBOLS

	MANUAL STATION - PULL STATION/FIRE ALARM BOX, 'XX' DENOTES TYPE: CO2 = CARBON DIOXIDE DC = DRY CHEMICAL HL = HALON F = FIRE ALARM FO = FOAM WC = WET CHEMICAL CA = CLEAN AGENT WM = WATER MIST DL = DELUGE FIRE SPRINKLER PRE = PREACTION
	ABORT SWITCH, 'XX' DENOTES TYPE: CO2 = CARBON DIOXIDE DC = DRY CHEMICAL HL = HALON F = FIRE ALARM FO = FOAM WC = WET CHEMICAL CA = CLEAN AGENT WM = WATER MIST DL = DELUGE FIRE SPRINKLER PRE = PREACTION

	HEAT DETECTOR/SENSOR (THERMAL DETECTION) ORIENTATION NOT TO BE CHANGED
	HEAT DETECTOR/SENSOR, 'XX' DENOTES TYPE: RF = COMBINATION RATE OF RISE/FIXED TEMPERATURE RC = RATE COMPENSATION F = FIXED TEMPERATURE R = RATE OF RISE ONLY
	HEAT DETECTOR - LINE TYPE
	SMOKE DETECTOR/SENSOR, 'XX' DENOTES TYPE: AS = AIR SAMPLING P = PHOTOELECTRIC I = IONIZATION R = RELAY BASE SS = SINGLE STATION SB = SOUNDER BASE ID = IN DUCT

	SMOKE/HEAT DETECTOR/SENSOR COMBINATION
	SMOKE DETECTOR/SENSOR - BEAM TRANSMITTER
	SMOKE DETECTOR/SENSOR - BEAM RECEIVER
	SMOKE DETECTION/SENSOR FOR DUCT
	GAS DETECTOR/SENSOR, 'XX' DENOTES TYPE: CO = CARBON MONOXIDE CO2 = CARBON DIOXIDE HCL = HYDROGEN CHLORIDE CH4 = METHANE

	FLAME DETECTOR, 'XX' DENOTES TYPE: UV = ULTRAVIOLET IR = INFRARED UVIR = COMBINATION ULTRAVIOLET/INFRARED VR = VISIBLE RADIATION
	FLOW DETECTOR/SWITCH
	PRESSURE DETECTOR/SWITCH
	VALVE SUPERVISORY SWITCH (TAMPER SWITCH)
	LEVEL DETECTOR/SWITCH, 'XX' DENOTES TYPE: HI = HIGH LO = LOW
	HIGH TEMPERATURE SWITCH
	LOW TEMPERATURE SWITCH
	ADDRESSABLE INPUT MODULE
	ADDRESSABLE OUTPUT MODULE
	ADDRESSABLE INPUT/OUTPUT MODULE # DENOTES NUMBER OF INPUTS AND OUTPUTS
	NON-ADDRESSABLE OUTPUT RELAY

CODE COMPLIANCE STATEMENTS:

ENERGY CODE STATEMENT:

TO THE BEST OF THE REGISTERED DESIGN PROFESSIONAL'S KNOWLEDGE, BELIEF AND PROFESSIONAL JUDGEMENT, THESE PLANS AND/OR SPECIFICATIONS ARE IN COMPLIANCE WITH THE 2020 ENERGY CODE.

UNIFORM CODE STATEMENT:

TO THE BEST OF THE REGISTERED DESIGN PROFESSIONAL'S KNOWLEDGE, BELIEF AND PROFESSIONAL JUDGEMENT, THESE PLANS AND/OR SPECIFICATIONS ARE IN COMPLIANCE WITH THE 2020 UNIFORM CODE.

NEW YORK STATE CODES NOTES

- THE FIRE ALARM SYSTEM AND ALL ASSOCIATED EQUIPMENT SHALL BE INSTALLED AND MAINTAINED IN ACCORDANCE WITH THE FULL REQUIREMENTS OF THE 2020 BUILDING CODE OF NEW YORK STATE, (SECTION BC 907), THE 2020 BCNYS.
- NO WORK SHALL BE STARTED UNTIL PLANS ARE APPROVED OR PERMITTED BY THE NEW YORK STATE AND FIRE DEPARTMENT. BEC FORM ED-16A SHALL BE FILED BY THE LICENSED ELECTRICAL CONTRACTOR WITH THE BUREAU OF ELECTRICAL CONTROL PRIOR TO ANY WORK.
- STROBE LIGHT SHALL BE APPROVED TO MEET CURRENT AMERICANS WITH DISABILITIES ACT (A.D.A.) AND TITLE 19 OF THE NY CODES, RULES AND REGULATIONS (19 NEW YORK CODES RULE AND REGULATIONS (NYCRR).
- NO CHANGES AND/OR MODIFICATIONS OF THE SYSTEM ARE ALLOWED WITHOUT THE DIRECTOR'S REPRESENTATIVE WRITTEN APPROVAL. WILL KEEP RECORDS OF ALL SUCH CHANGES. IF ANY SUBSTANTIAL CHANGES TO THE APPROVED PLANS WERE MADE PREVIOUS TO OR DURING THE INSTALLATION, AS-BUILT PLANS SHALL BE PREPARED BY THE ENGINEER AND FILED WITH NEW YORK STATE AGENCIES FOR FINAL ACCEPTANCE.
- FIRE ALARM CONTROL PANELS SHALL BE MOUNTED WITH 3 FEET CLEARANCE FOR TESTING AND OBSERVATION. TOP OF THE PANEL SHALL BE AT 5'-6". ALL EXISTING FIRE ALARM EQUIPMENT NO LONGER USED SHALL BE REMOVED UPON APPROVAL OF THE NEW FIRE ALARM SYSTEM.
- NO CONDUITS OR WIRES SHALL ENTER THE TOP OF THE FIRE ALARM PANEL. ANY PRE-MADE OPENINGS IN THE TOP OF THE PANEL SHALL BE BLANKED AND SEALED. ALL CONTROLS, FUNCTION SWITCHES, ETC. SHALL BE CLEARLY LABELED ON ALL FIRE ALARM EQUIPMENT PANELS.
- ALL CABLING SHALL BE TEFLON INSULATED AND JACKETED, L.L. APPROVED FOR FIRE PROTECTION SERVICE PER 2022 NYS FIRE CODE.

SYSTEM INPUT	SYSTEM OUTPUT											
	ILLUMINATE ALARMED ON CONTROL PANEL	ACTIVATE PRE-ACTION STROBE	ACTIVATE ALARM CONTACTS FOR BUILDING SYSTEM NOTIFICATION	DISPLAY ALARM SYSTEM MESSAGES WITH POINT IDENTIFICATION ON DISPLAY	ACTIVATE SOLID STATE VALVE TO FLOW WATER	ILLUMINATE SUPERVISORY ON CONTROL PANEL	DISPLAY SUPERVISORY STATUS MESSAGE ON CONTROL PANEL	SEND SUPERVISORY SIGNAL TO BUILDING FIRE ALARM SYSTEM	SEND COMMON TROUBLE SIGNAL TO BUILDING MANAGEMENT SYSTEM	ILLUMINATE TROUBLE LED ON CONTROL PANEL	DISPLAY TROUBLE STATUS MESSAGE	ACTIVATE FAN SHUTDOWN RELAY (AV)
HEAT DETECTOR	✓	✓	✓	✓	✓							✓
PRE-ACTION MANUAL PULL STATION	✓	✓	✓	✓								✓
WATER FLOW PRESSURE SWITCH	✓	✓	✓	✓								✓
TAMPER MONITORING SWITCH						✓	✓	✓				
LOW AIR MONITORING SWITCH						✓	✓	✓				
FAILURE OF SYSTEM AND COMPONENTS									✓	✓	✓	

PRE-ACTION SEQUENCE OF OPERATION MATRIX

Fire Alarm Audibility - Design Criteria		
Location	Average Ambient Sound Level [dBA]	Design Goal [dBA]
Business Occupancies	55	MIN. 70
Educational Occupancies	45	MIN. 60
Industrial Occupancies	80	MIN. 95
Institutional Occupancies	50	MIN. 65
Mercantile Occupancies	40	MIN. 55
Mechanical Rooms	85	MIN. 100
Places of Assembly	55	MIN. 70
Residential Occupancies	35	MIN. 75
Storage Occupancies	30	MIN. 45

The maximum sound pressure level for audible alarm notification appliances shall be 110dBA max at minimum hearing distance from the audible appliance.

FIRE ALARM SYSTEM OUTPUTS

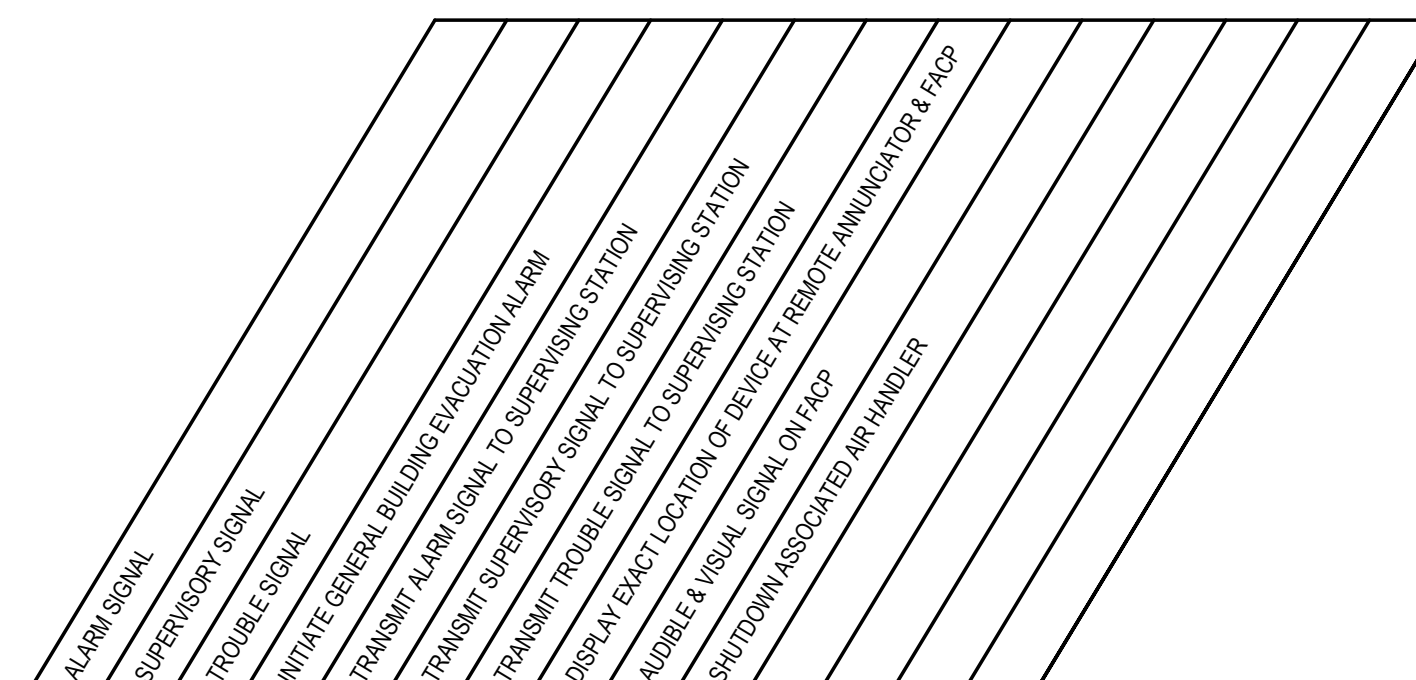

FIRE ALARM SYSTEM INPUTS

	A	B	C	D	E	F	G	H	I	J	K	L	M	N
1. MANUAL PULL STATION	X	X		X	X				X	X				
2. AREA HEAT/SMOKE DETECTOR	X	X		X	X				X	X				
3. DUCT SMOKE DETECTOR	X	X		X	X				X	X	X			
4. FIRE ALARM AC POWER FAILURE			X	X			X	X						
5. FIRE ALARM SYSTEM LOW BATTERY			X			X	X							
6. OPEN CIRCUIT			X			X	X							
7. GROUND FAULT			X			X	X							
8. NOTIFICATION APPLIANCE CKT SHORT			X			X	X							
9. VESDA ALARM	X	X	X	X	X	X	X	X	X	X	X			
10. VESDA TROUBLE			X	X	X	X	X	X	X	X				

FIRE ALARM GENERAL NOTES:

- PRIOR TO BID, CONTACT THE BUILDING FIRE ALARM MAINTENANCE VENDOR AND OBTAIN PRICING FOR THE EQUIPMENT AND SERVICES LISTED BELOW WHICH MUST BE PROVIDED BY THAT CONTRACTOR.
- ALL EQUIPMENT FURNISHED AND INSTALLED BY ELECTRICAL CONTRACTOR AND SHALL BE PURCHASED FROM THE BUILDING FIRE ALARM MAINTENANCE CONTRACTOR TO ASSURE COMPATIBILITY WITH FIRE ALARM SYSTEM.
- REPROGRAMMING OF FIRE ALARM CONTROL PANEL (FACP) AND FINAL CONNECTIONS AT THE FACP OR DATA GATHERING PANELS ARE BY BUILDING'S FIRE ALARM MAINTENANCE CONTRACTOR. INCLUDE VENDOR COST IN BID PRICE.
- INSTALL FIRE ALARM EQUIPMENT, FIRE ALARM SPEAKER AND STROBE LIGHTS (ADA TYPE, CANDELA) UNITS AT LOCATION INDICATED ON THE PLAN.
- FIRE ALARM RECESSED CEILING MOUNTED SPEAKER AND WALL MOUNTED STROBE LIGHT UNITS OR COMBINATION SPEAKER/STROBE UNITS SHALL BE BASE MOUNTED TYPE.
- ALL CABLING SHALL BE TEFLON INSULATED AND JACKETED, FIRE PROTECTION SERVICE APPROVED, (1) PAIR # 14 AWG FOR STROBES AND "POINTS" WIRING AND # 16 AWG FOR SPEAKER. PROVIDE SHIELD WIRING WHERE REQUIRED. FIRE ALARM WIRING SHALL BE LABELED "ALSO CLASSIFIED NYC CERTIFIED FIRE ALARM CABLE."
- EXISTING BUILDING SYSTEMS ARE NOT SHOWN (UNLESS THEY ARE PART OF INSTALLATIONS).
- OBTAIN PERMISSION FROM DIRECTOR'S REPRESENTATIVE PRIOR TO RUNNING WIRE FROM NEW FIRE ALARM DEVICES TO FIRE FIRE ALARM CONTROL PANEL OR DATA GATHERING PANELS.
- ALL ROUTING OF CABLES TO FIRE ALARM CONTROL PANEL OR DATA GATHERING PANELS (DGP) SHALL BE DIRECTED AND APPROVED BY DIRECTOR'S REPRESENTATIVE.
- THE PARTIAL FIRE ALARM RISER DIAGRAM SHOWN IS AN INDICATION OF THE WORK REQUIRED AND SHALL BE USED FOR ESTIMATING PURPOSES ONLY. OBTAIN A POINT-TO-POINT WIRING DIAGRAM FROM THE BUILDING FIRE ALARM MAINTENANCE CONTRACTOR AND PERFORM ALL WORK IN ACCORDANCE WITH THAT DIAGRAM. SUBMIT THIS WIRING DIAGRAM TO DIRECTOR'S REPRESENTATIVE FOR REVIEW. ALSO IN ADDITION, A FIRE ALARM AS-BUILT SHALL BE PROVIDED TO THE DIRECTOR'S REPRESENTATIVE, DUPLICATION OF ENGINEER'S DRAWING WILL NOT BE APPROVED.
- THE OPERATION OF THE FIRE ALARM INSTALLATION DOES NOT CONSTITUTE AN ACCEPTANCE OF THE WORK BY THE DIRECTOR'S REPRESENTATIVE. FINAL ACCEPTANCE IS TO BE MADE AFTER THE CONTRACTOR HAS DEMONSTRATED THAT THE WORK FULFILLS THE REQUIREMENTS OF THE PLANS AND SPECIFICATIONS AND HAS FURNISHED ALL REQUIRED CERTIFICATES OF APPROVAL FROM THE STATE AUTHORITIES, MUNICIPAL AUTHORITIES AND UNDERWRITERS.
INCLUDE ALL FEES, COSTS, ETC. FOR FILING ALL REQUIRED FORMS AND DRAWINGS FOR THE NEW YORK STATE DEPARTMENT, APPROVALS, FINAL CONNECTIONS, SYSTEM PROGRAMMING, PRE-TESTING AND FIRE DEPARTMENT TESTING AND SIGNOFF.
SPEAKER AND STROBES SHALL BE WIRED ON ALTERNATING CIRCUITS IN ALL AREAS.
ALL SMOKE AND COMBINATION FIRE/SMOKE DAMPERS SHALL BE PROVIDED WITH A REMOTE LAMP INDICATOR. PROVIDE ALL NECESSARY CONTROL & MONITOR MODULES, AND RELAYS TO PROVIDE PROPER OPERATION OF FIRE SMOKE DAMPERS.
WHERE (2) STROBES ARE VISIBLE TO A SPECIFIC LOCATION, THEY MUST BE SYNCHRONIZED. PROVIDE SYNCHRONIZATION MODULES AS REQUIRED.
- INCLUDE IN BID ALL DEVICES REQUIRED BY THE LOCAL FIRE ALARM INSPECTIONS, BUT NOT LIMITED TO SMOKE DETECTORS, PULL STATIONS, INTERFACE RELAYS, CONTROL PANELS, POWER, BOOSTER PANELS, STROBE PANELS, ADDITIONAL AMPLIFIERS, SOFTWARE ETC.
- ALL WORK SHALL BE DONE IN ACCORDANCE WITH CODE ARTICLE 760 (NEC) SECTION 606 OF THE LATEST VERSION OF MECHANICAL CODE AND ALL OTHER APPLICABLE CODES AND REGULATIONS.
- AFTER COMPLETION OF ALL FIRE ALARM SCOPE AND FULL PRE-TEST WITNESSED BY THE INSTALLING LICENSED ELECTRICAL CONTRACTOR AND FIRE ALARM VENDOR. ELECTRICAL CONTRACTOR SHALL ACCOMPANY THE FIRE DEPARTMENT INSPECTOR DURING HIS INSPECTION OF THE SYSTEM. ELECTRICAL CONTRACTOR SHALL COORDINATE WITH AHJ FOR PROPER PROCEDURES OF THE INSPECTION PROCESS.
- ALL WIRING INCLUDING THE GROUNDING TO BE INSTALLED ACCORDANCE WITH NEW YORK STATE ELECTRICAL 2017 CODE.
- DO NOT RUN FIRE ALARM CABLE IN THE SAME RACEWAY WITH NON FIRE ALARM CABLE.
- ALL FIRE ALARM DEVICES SHALL BE FLUSH MOUNTED, UNLESS OTHERWISE NOTED.
- SPEAKER/STROBE DEVICES SHALL NOT HAVE ANY OTHER DEVICES OR APPARATUS WITHIN FIVE (5) FEET OF DEVICE.
- AT THE COMPLETION OF WORK, DELIVER FDNY LETTER OF APPROVAL TO DIRECTOR'S REPRESENTATIVE. PROVIDE COPIES OF APPROVED FIRE ALARM PLANS AND ALL APPLICABLE FORMS TO DIRECTOR'S REPRESENTATIVE.
- AVOID INSTALLING FIRE ALARM CABLES NEAR SOURCES OF ALTERNATING CURRENT. (LIGHTING, POWER) ETC.
- ALL NEW EXPOSED TEFLON WIRING SHALL BE SLEEVED AND SEALED AT ALL FIRE RATED WALL AND FLOOR PASSAGES. SEALANT SHALL BE 3M FIRE BARRIER CP-25.
- OBSERVE ALL POLARITY ON ALL FIRE ALARM CIRCUITS. NO TEE TAPPING IS PERMITTED ON ALARM INDICATING CIRCUITS.(STROBES, HORN, ETC)
- FIRE ALARM RISER DIAGRAM SHOWN IS FOR GENERAL ARRANGEMENT AND SHALL BE USED FOR ESTIMATING ONLY. VERIFY EXISTING FIELD CONDITIONS AND OBTAIN POINT TO POINT WIRING DIAGRAM FROM FIRE ALARM VENDOR TO INSTALLATION THAT IS CONSISTENT WITH FDNY REQUIREMENTS.
- ALL EQUIPMENT SHALL BE UL LISTED AND SHALL MEET REQUIREMENTS OF NFPA 72 AND 90A, ALL APPLICABLE CODES AND LOCAL LAWS AND BE INSTALLED AND CONNECTED IN ACCORDANCE WITH THE MANUFACTURERS' RECOMMENDATIONS AND INSTRUCTIONS. ALL FINAL CONNECTIONS TO BE MADE BY THIS CONTRACTOR.
- FIRE ALARM CABLES SHALL COMPLY WITH THE FOLLOWING REQUIREMENTS:
a. A MINIMUM TEMPERATURE RATING OF 150 DEGREE CELSIUS.
b. A MINIMUM AVERAGE INSULATION THICKNESS OF 15 MILS.
c. A MINIMUM AVERAGE JACKET THICKNESS OF 25 MILS.
d. THE COLOR OF THE CABLE SHALL BE RED.
e. THE CABLE SHALL BE TYPE FPLP (PLENUM TYPE)
f. THE CABLE SHALL BE VISIBLY MARKED EXTERNALLY "THE ALARM".
g. THE CABLE SHALL MEET THE ABOVE REQUIREMENTS AND HAVE UL 1424 AND UL 910 LISTING.
h. CABLES SHALL BE APPROVED FOR LOCAL AHJ.
i. CABLES SHALL BE INSTALLED IN ACCORDANCE WITH (NEC) NFPA STANDARDS AND ALL OTHER APPLICABLE CODES AND REGULATIONS.
- THE SYSTEM SHALL BE PRE-TESTED IN THE PRESENCE OF THE DIRECTOR'S REPRESENTATIVE. DURING NON BUSINESS HOURS AS PART OF THE CONTRACT, INSTALLER SHALL BE RESPONSIBLE FOR PROVIDING A SYSTEM ACCEPTABLE TO THE DIRECTOR'S REPRESENTATIVE AND SHALL PROVIDE ANY ADDITIONAL TESTING AND ADJUSTING AT NO ADDITIONAL COST TO THE SATISFACTION TO THE DIRECTOR'S REPRESENTATIVE AFTER SUCCESSFUL COMPLETION OF PRE-TEST.
- THE OPERATION OF THE FIRE ALARM INSTALLATION DOES NOT CONSTITUTE AN ACCEPTANCE OF THE WORK BY THE DIRECTOR'S REPRESENTATIVE. FINAL ACCEPTANCE IS TO BE MADE AFTER THE CONTRACTOR HAS DEMONSTRATED THAT THE WORK FULFILLS THE REQUIREMENTS OF THE PLANS AND SPECIFICATIONS AND HAS FURNISHED ALL REQUIRED CERTIFICATES OF APPROVAL FROM THE STATE AUTHORITIES, MUNICIPAL AUTHORITIES AND UNDERWRITERS.
- HORN/STROBE DEVICES SHALL BE INSTALLED IN ALL COMMON AREAS SO THAT NO SPACE IS MORE THAN 50'-0" FROM A HORN/STROBE. ADD ADDITIONAL DEVICE IN ORDER TO COMPLY NFPA 72-2016 EDITION.
- END OF LINE RESISTOR LOCATIONS SHALL BE PERMANENTLY LABELED ON INSTALLED DEVICE IN FIELD RESISTORS TO BE SHOWN ON AS-BUILT PLANS THROUGHOUT THE FLOORS.
- AFTER THE SYSTEM MODIFICATIONS ARE COMPLETE, TEST ALL COMPONENTS IN ACCORDANCE WITH SEQUENCE OF OPERATIONS.
- AFTER ALARM INDICATION ALL FANS SHALL BE MANUALLY RESET INDEPENDENT OF FCS RESET.
- ALL FIRE ALARM CONTROL PANELS SHALL BE MOUNTED WITHIN 3' FEET CLEARANCE FOR TESTING AND OBSERVATION. TOP OF PANEL SHALL BE AT 6'-6". ALL EXISTING FIRE ALARM EQUIPMENT NO LONGER USED SHALL BE REMOVED UPON APPROVAL OF THE NEW SYSTEM.
- FOR ALL ASSOCIATED FIRE ALARM WORK, COORDINATE WITH FIRE ALARM VENDOR 'JC'. KERRY ANN KUHN AT KERRY.ANN.KUHN@JCI.COM (1-845-742-1431) VIA DIRECTOR'S REPRESENTATIVE.
- FOR SECURITY CAMERA AND DOOR ACCESS CONTROLS REFER TO ROBERT Mc CLEAN AT Robert.McClean@jci.com. 1-585-259-2217
- PAINT FIRE ALARM CONDUIT BODY COVERS RED COLOR AND BOXES WITH ENAMEL RED COLOR.

DRAWING LIST	
DRAWING No.	DRAWING TITLE
FA-000	FIRE ALARM COVER SHEET
FA-100	FIRE ALARM CELLAR FLOOR PLAN
FA-200	FIRE ALARM FIRST FLOOR PLAN
FA-300	FIRE ALARM COMMON SHEET



CONSULTANTS:

CERTIFICATE OF AUTHORIZATION #: 0020083

ARCHITECT:

JACK L. GORDON ARCHITECTS
MEP/FP/FA/ENGINEER:
LEGACY ENGINEERS
SITE/CIVIL ENGINEER:
HAYDUK ENGINEERING
GEOTECHNICAL ENGINEER:
HARTLAND ENGINEERING
STRUCTURAL ENGINEER:
YSRAEL A. SEINUK, PC
IT CONSULTANT:
CERAMI & ASSOCIATES

ENERGY CODE STATEMENT

TO THE BEST OF THE ARCHITECT/ENGINEER'S KNOWLEDGE, BELIEF AND PROFESSIONAL JUDGEMENT, THESE PLANS AND/OR SPECIFICATIONS ARE IN COMPLIANCE WITH THE 2020 NEW YORK STATE ENERGY CODE.

2020 NEW YORK STATE FIRE CODE AND BUILDING CODE
1. TO THE BEST OF THE KNOWLEDGE, BELIEF AND PROFESSIONAL JUDGEMENT OF THE LICENSED PROFESSIONAL SEALING THESE PLANS AND SPECIFICATIONS, THESE PLANS ARE IN COMPLIANCE WITH THE 2020 NEW YORK STATE FIRE CODE AND BUILDING CODE.

WARNING:

THE ALTERATION OF THIS MATERIAL IN ANY WAY, UNLESS DONE UNDER THE DIRECTION OF A COMPARABLE PROFESSIONAL, I.E., ARCHITECT FOR AN ARCHITECT, ENGINEER FOR AN ENGINEER OR LANDSCAPE ARCHITECT FOR A LANDSCAPE ARCHITECT, IS A VIOLATION OF THE NEW YORK STATE EDUCATION LAW AND/OR REGULATIONS AND IS A CLASS "A" MISDEMEANOR.

REGISTRATION EXPIRES:

CONTRACT:

FIRE ALARM

TITLE:
PROVIDE IMAGING BAY,
BUILDING 35

LOCATION:
NATHAN KLINE RESEARCH INSTITUTE
140 OLD ORANGEBURG RD.
ORANGEBURG, NY

CLIENT:
NEW YORK STATE
OFFICE OF MENTAL HEALTH

	05/18/2025	BID DOCUMENT
	11/11/2025	REVISED DRAWING

MARK DATE DESCRIPTION

PROJECT NUMBER: 46218-FA

DESIGNED BY:

DRAWN BY: LE

FIELD CHECK:

APPROVED: LE

SHEET TITLE:

FIRE ALARM COVER SHEET

DRAWING NUMBER:

FA-000

SHEET

1 OF 4

CONSULTANTS:
CERTIFICATE OF AUTHORIZATION #: 0020083

ARCHITECT:
JACK L. GORDON ARCHITECTS
MEP/FP/FA/ENGINEER:
LEGACY ENGINEERS
SITE/CIVIL ENGINEER:
HAYDUK ENGINEERING
GEOTECHNICAL ENGINEER:
HARTLAND ENGINEERING
STRUCTURAL ENGINEER:
YSRAEL A. SEINUK, PC
IT CONSULTANT:
CERAMI & ASSOCIATES

ENERGY CODE STATEMENT:
TO THE BEST OF THE ARCHITECT/ENGINEER'S KNOWLEDGE, BELIEF AND PROFESSIONAL JUDGEMENT, THESE PLANS AND/OR SPECIFICATIONS ARE IN COMPLIANCE WITH THE 2020 NEW YORK STATE ENERGY CODE.
2020 NEW YORK STATE FIRE CODE AND BUILDING CODE
1. TO THE BEST OF THE KNOWLEDGE, BELIEF AND PROFESSIONAL JUDGEMENT OF THE LICENSED PROFESSIONAL SEALING THESE PLANS AND SPECIFICATIONS, THESE PLANS ARE IN COMPLIANCE WITH THE 2020 NEW YORK STATE FIRE CODE AND BUILDING CODE.

WARNING:
THE ALTERATION OF THIS MATERIAL IN ANY WAY, UNLESS DONE UNDER THE DIRECTION OF A COMPARABLE PROFESSIONAL, I.E. ARCHITECT FOR AN ARCHITECT, ENGINEER FOR AN ENGINEER OR LANDSCAPE ARCHITECT FOR A LANDSCAPE ARCHITECT, IS A VIOLATION OF THE NEW YORK STATE EDUCATION LAW AND/OR REGULATIONS AND IS A CLASS "A" MISDEMEANOR.

REGISTRATION EXPIRES:

CONTRACT:
FIRE ALARM

TITLE:
PROVIDE IMAGING BAY,
BUILDING 35

LOCATION:
NATHAN KLINE RESEARCH INSTITUTE
140 OLD ORANBURG RD.
ORANBURG, NY

CLIENT:
NEW YORK STATE
OFFICE OF MENTAL HEALTH

	05/18/2025	BID DOCUMENT
⚠	11/11/2025	REVISED DRAWING

MARK	DATE	DESCRIPTION
PROJECT NUMBER:	46218-FA	
DESIGNED BY:		
DRAWN BY:	LE	
FIELD CHECK:		
APPROVED:	LE	

SHEET TITLE:
FIRE ALARM CELLAR FLOOR
PLAN

DRAWING NUMBER:
FA-100

DRAWING NOTES:

- ALL FIRE ALARM WORK SHOWN IS NEW UNLESS OTHERWISE NOTED ON THIS DRAWING. "E" DENOTES EXISTING TO REMAIN.
- REFER TO DRAWINGS FA-200.00 FOR PARTIAL FIRE ALARM RISER DIAGRAM AND DETAILS.

KEY NOTES:

- FOR ALL CONVENTIONAL TYPE (NON-ADDRESSABLE) FIRE ALARM DEVICES SHOWN (FIRE ALARM SMOKE/DUCT DETECTORS & MANUAL PULL STATION) PROVIDE ADDRESSABLE INPUT MODULES IN ORDER TO IDENTIFY THE FIRE ALARM DEVICE TYPE .DEVICE LOCATION AND ASSOCIATED ALARM FUNCTION. COORDINATE ALL WORK WITH FACILITY FIRE ALARM VENDOR JCI.

CODE COMPLIANCE STATEMENTS:

ENERGY CODE STATEMENT:
TO THE BEST OF THE REGISTERED DESIGN PROFESSIONAL'S KNOWLEDGE, BELIEF AND PROFESSIONAL JUDGEMENT, THESE PLANS AND/OR SPECIFICATIONS ARE IN COMPLIANCE WITH THE 2020 ENERGY CODE.

UNIFORM CODE STATEMENT:
TO THE BEST OF THE REGISTERED DESIGN PROFESSIONAL'S KNOWLEDGE, BELIEF AND PROFESSIONAL JUDGEMENT, THESE PLANS AND/OR SPECIFICATIONS ARE IN COMPLIANCE WITH THE 2020 UNIFORM CODE.

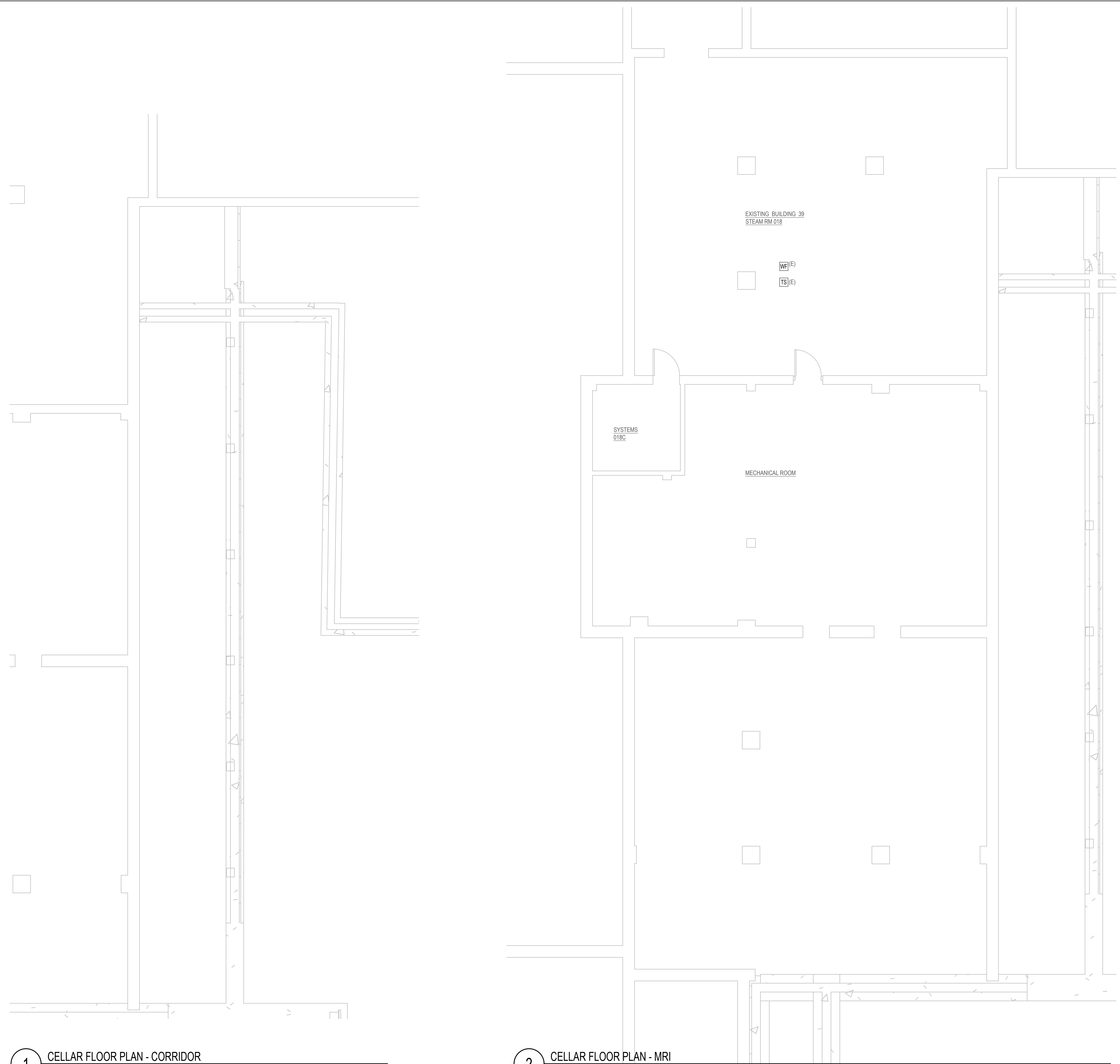

1 CELLAR FLOOR PLAN - CORRIDOR
SCALE: 3/16"=1'-0"

2 CELLAR FLOOR PLAN - MRI
SCALE: 3/16"=1'-0"

17/45 1A

FACP Field Wiring Diagram

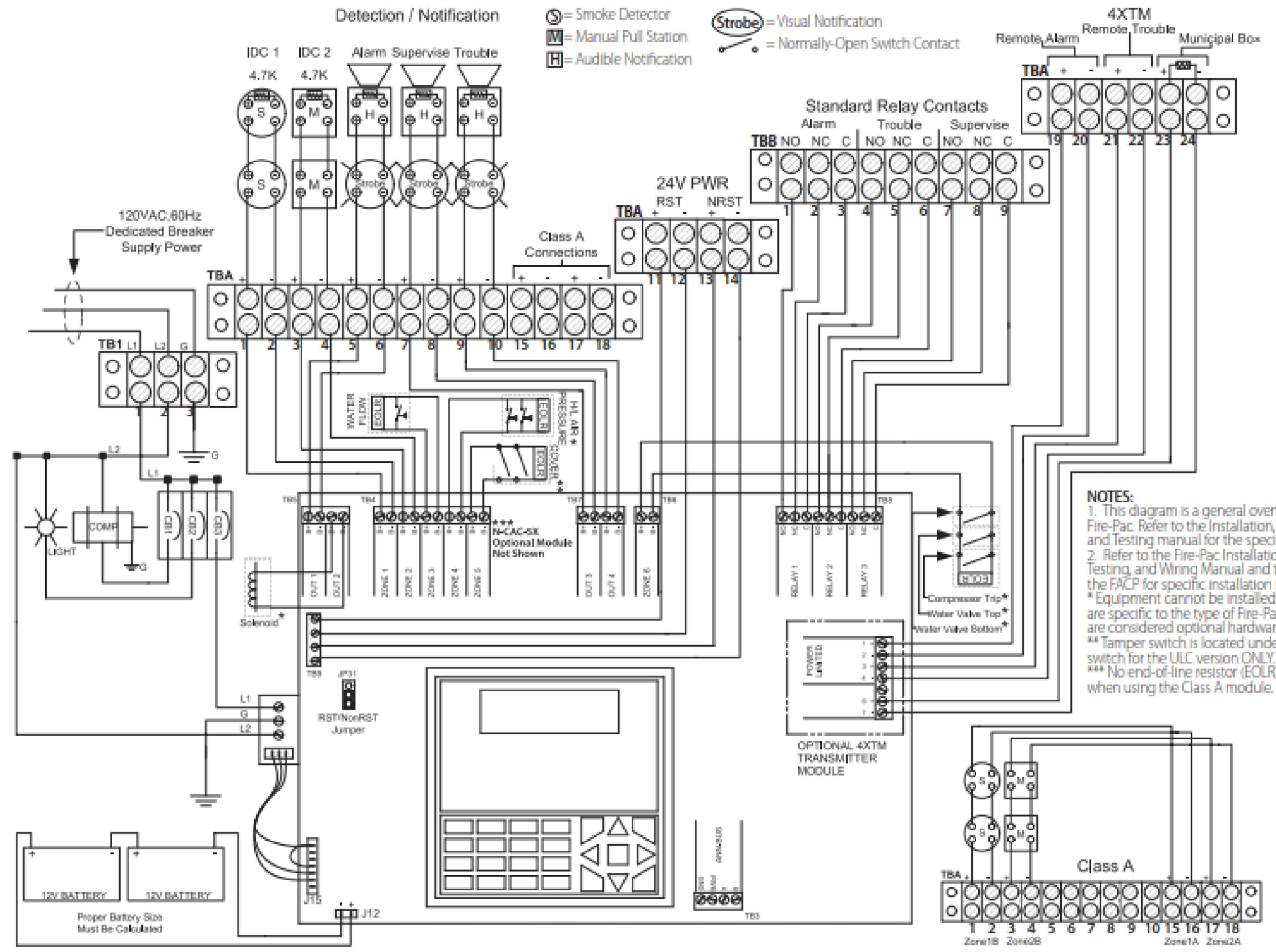

NOTES:
 1. This diagram is a general overview of a typical Fire-Pac. Refer to the Installation, Maintenance, and Testing manual for the specific system.
 2. Refer to the Fire-Pac Installation, Maintenance, Testing, and Wiring Manual and the manual for the FACP for specific installation instructions.
 * Equipment cannot be installed. These devices are specific to the type of Fire-Pac ordered and are considered optional hardware.
 ** Tamper switch is located under each pressure switch for the ULG version ONLY.
 *** No end-of-line resistor (EOLR) is needed when using the Class A module.

FIRE ALARM RISER DIAGRAM NOTES:

- THIS IS NOT A POINT-TO-POINT WIRING DIAGRAM. USE THIS DIAGRAM FOR ESTIMATING PURPOSES ONLY. PRIOR TO STARTING ANY WORK, A WORKING POINT-TO-POINT WIRING DIAGRAM SHALL BE OBTAINED FROM BUILDING FIRE ALARM MAINTENANCE CONTRACTOR.
- FACP PANEL TO ACCOMMODATE FIRE ALARM DEVICES NOTED ON RISER DIAGRAM. COORDINATE WITH BUILDING FIRE ALARM VENDOR TO VERIFY FACP CAPACITY PRIOR TO PRICING.
- CONNECT ALL STROBE AND COMBINATION SPEAKER-STROBE LIGHT UNITS TO (TWO) ALTERNATE ZONES AND SHALL BE SYNCHRONIZED. COORDINATE WITH DIRECTOR'S REPRESENTATIVE AND/OR LEGACY ENGINEERS FOR EXACT MOUNTING LOCATIONS PER FIELD CONDITIONS.
- SEE FIRE ALARM FLOOR PLAN FOR EXACT QUANTITY OF FIRE ALARM DEVICES. WHERE DISCREPANCIES ARE INDICATED FOR QUANTITIES ASSUME THE GREATER COUNT IN BID DOCUMENTS.
- LOCATION OF FIRE ALARM DEVICES SHALL BE APPROVED BY AHJ & DIRECTOR'S REPRESENTATIVE PRIOR TO INSTALLATION.
- COORDINATE OPERATION OF FIRE ALARM SYSTEM WITH BASE BUILDING FIRE ALARM MANUFACTURER "JOHNSON CONTROL FIRE PROTECTION".
- ALL FIRE ALARM TIE-IN SHALL BE DONE BY "JIC". BUILDING FIRE ALARM MAINTENANCE CONTRACTOR.
- THE FIRE ALARM SYSTEM MUST BE KEPT OPERATIONAL THROUGHOUT THE DURATION OF THE WORK. SMOKE DETECTORS MUST BE PROTECTED IF THE WORK WILL CAUSE DUST AND DIRT AND THE DEVICE MUST BE PUT BACK ON LINE AT THE END OF EVERY DAY. IF THE SYSTEM IS TAKEN OFF-LINE FOR MORE THAN THE DAY, THEN A FIRE WATCH IS REQUIRED TO BE PROVIDED BY THE FACILITY.
- PROVIDE REMOTE LED INDICATORS FOR ALL NEW AND NEW DUCT DETECTORS.
- PROVIDE END OF LINE RESISTOR ON EACH FLOOR LOOP AS REQUIRED.
- FIRE ALARM SYSTEM RISER SHALL BE INSTALLED FOLLOWING THE REQUIREMENTS OF PATHWAY SURVIVABILITY LEVEL 2 FOR EACH CIRCUIT.

KEY NOTES:

- PROVIDE AND COORDINATE ALL REQUIRED SELF-CONTAINED PRE-ACTION SYSTEM WIRING AND DEVICES WITH PRE-ACTION SYSTEM VENDOR PRIOR TO INSTALLATION. (PRE-ACTION SYSTEM SOLENOID VALVE, LOW PRESSURE SWITCH ARE INTEGRAL WITHIN UNIT) INCLUDING BUT NOT LIMITED TO ALARM "TROUBLE" SUPERVISORY & ALARM CONDITION DEVICES". ELECTRICAL CONTRACTOR SHALL PROVIDE ALL REQUIRED INTERFACE MODULES AND WIRING NECESSARY FOR A COMPLETE OPERABLE SYSTEM BETWEEN NEW SELF-CONTAINED PRE-ACTION PANEL AND EXISTING FIRE ALARM CONTROL PANEL AT NO ADDITIONAL COST TO FACILITY.
- PROVIDE NEW FUSE CUT-OUT FOR NEW SELF-CONTAINED PRE-ACTION PANEL TAPPED AHEAD OF LIFE SAFETY PANEL IN ELECTRIC CLOSET.

DOUBLE INTERLOCK PREACTION SYSTEM SEQUENCE OF OPERATION

- THE PREACTION SYSTEM SHALL UTILIZE ELECTRIC/PNEUMATIC RELEASE.
- ACTIVATION OF ANYONE (1) OF THE PREACTION SYSTEM SMOKE DETECTORS SHALL SEND A SIGNAL TO THE EXISTING SIMPLEX 4100ES FIRE ALARM CONTROL PANEL WITH PREACTION SPRINKLER SYSTEM RELEASING CONTROL.
- UPON RECEIVING A SIGNAL FROM ANY OF THE PREACTION SYSTEM SMOKE DETECTORS, THE 4100ES FIRE ALARM CONTROL PANEL WITH PREACTION SPRINKLER SYSTEM RELEASING CONTROL SHALL OPEN THE PREACTION SOLENOID VALVE AND ACTIVATE A SUPERVISORY SIGNAL AT THE BUILDING FIRE ALARM CONTROL PANEL.
- PREACTION SYSTEM PIPING SHALL NOT FILL WITH WATER UPON ACTIVATION OF SMOKE DETECTION ALONE.
- FUSING ANY OF THE SPRINKLERS THAT ARE PART OF THE PREACTION SYSTEM SHALL CAUSE A DECREASE IN THE SYSTEM OF AIR PRESSURE AND IN TURN ALLOW RELEASE OF THE AIR PRESSURE ON THE PNEUMATIC ACTUATOR ALLOWING IT TO OPEN. THE DECREASE IN THE SYSTEM AIR PRESSURE DUE TO A SPRINKLER FUSING SHALL ACTIVATE A SUPERVISORY SIGNAL AT THE BUILDING FIRE ALARM CONTROL PANEL.
- PREACTION SYSTEM PIPING SHALL NOT FILL WITH WATER DUE TO A DECREASE IN THE SYSTEM OF AIR PRESSURE ALONE.
- OPERATION OF BOTH THE PNEUMATIC ACTUATOR (SPRINKLER FUSING) AND THE SOLENOID VALVE (SMOKE DETECTOR ACTIVATION) SHALL OPEN THE DELUGE VALVE FILLING THE SPRINKLER SYSTEM WITH WATER AND ACTIVATING AN ALARM SIGNAL AT THE BUILDING FIRE ALARM CONTROL PANEL.
- PREACTION SYSTEM RELEASING CONTROL (ADDED TO EXISTING SIMPLEX 4100ES FACP), 24V SOLENOID VALVE CIRCUITS, AND ALL FIRE ALARM SIGNAL WIRING ARE PROVIDED BY THE E-CONTRACT. REFER TO E-DWGS.

DOUBLE INTERLOCK SEQUENCE OF OPERATION FOR PRE-ACTION SYSTEM

CODE COMPLIANCE STATEMENTS:

ENERGY CODE STATEMENT:
 TO THE BEST OF THE REGISTERED DESIGN PROFESSIONAL'S KNOWLEDGE, BELIEF AND PROFESSIONAL JUDGEMENT, THESE PLANS AND/OR SPECIFICATIONS ARE IN COMPLIANCE WITH THE 2020 ENERGY CODE.

UNIFORM CODE STATEMENT:
 TO THE BEST OF THE REGISTERED DESIGN PROFESSIONAL'S KNOWLEDGE, BELIEF AND PROFESSIONAL JUDGEMENT, THESE PLANS AND/OR SPECIFICATIONS ARE IN COMPLIANCE WITH THE 2020 UNIFORM CODE.

CIRCUIT SCHEDULE						
CIRCUIT ID	PATHWAY DESCRIPTION	WIRE TYPE	MINIMUM CONDUIT SIZE	INDOOR	PATHWAY CLASS (2010 ED) SURVIVABILITY REQUIREMENT	MINIMUM NFPA 72 LEVEL
A	SIGNALING LINE CIRCUITS (SLC)	2#16AWG TWISTED SHIELDED	3/4"	RGS	X	LEVEL 0
B	BRIGER CAMPUS WIDE FIBER OPTIC NETWORK	12-STRAND MULTIMODE 50/125u M FIBER	3/4"	RGS	A	LEVEL 0
C	DATA COMMUNICATION BETWEEN PANELS	2#14AWG TWISTED SHIELDED	3/4"	RGS	A	LEVEL 3*
D	DIGITAL AUDIO COMMUNICATION BETWEEN PANELS	2#14AWG TWISTED SHIELDED	3/4"	RGS	A	LEVEL 3*
E	SPEAKER CIRCUITS**	2#14AWG TWISTED SHIELDED	3/4"	RGS	A	LEVEL 3*
F	STROBE CIRCUITS	2#14AWG SHIELDED	3/4"	RGS	A	LEVEL 3*
G	CONTROL CIRCUITS	2#16AWG SHIELDED	3/4"	RGS	N/A	LEVEL 0
H	MONITORING CIRCUITS	2#16AWG SHIELDED	3/4"	RGS	A	LEVEL 0
I	ANNUNCIATOR CIRCUIT	2#14AWG SHIELDED	3/4"	RGS	A	LEVEL 0
J	PANEL POWER	2#12AWG SHIELDED	3/4"	RGS	N/A	LEVEL 0
K	24V POWER	2#12AWG TWISTED SHIELDED	3/4"	RGS	N/A	LEVEL 0
L	SYNC COMMUNICATIONS BETWEEN PANELS	2#12AWG TWISTED SHIELDED	3/4"	RGS	N/A	LEVEL 3*
M	DATA COMMUNICATIONS BETWEEN PANELS UNDERGROUND	2-STRANDS MULTIMODE 62.5/125uM FIBER	3/4"	RGS	A	LEVEL 3*
N	DIGITAL AUDIO COMMUNICATIONS BETWEEN PANELS UNDERGROUND		3/4"	RGS	A	LEVEL 3*

* CONTRACTOR TO PROVIDE MINIMUM 15FT SPACING FOR CLASS "A" AND CLASS "X" WIRING IN LIEU OF 2-HOUR RATED CIRCUIT INTEGRITY IN ORDER TO COMPLY WITH THE NEW YORK STATE BUILDING CODE SECTION NEC - NFPA 70(2017)

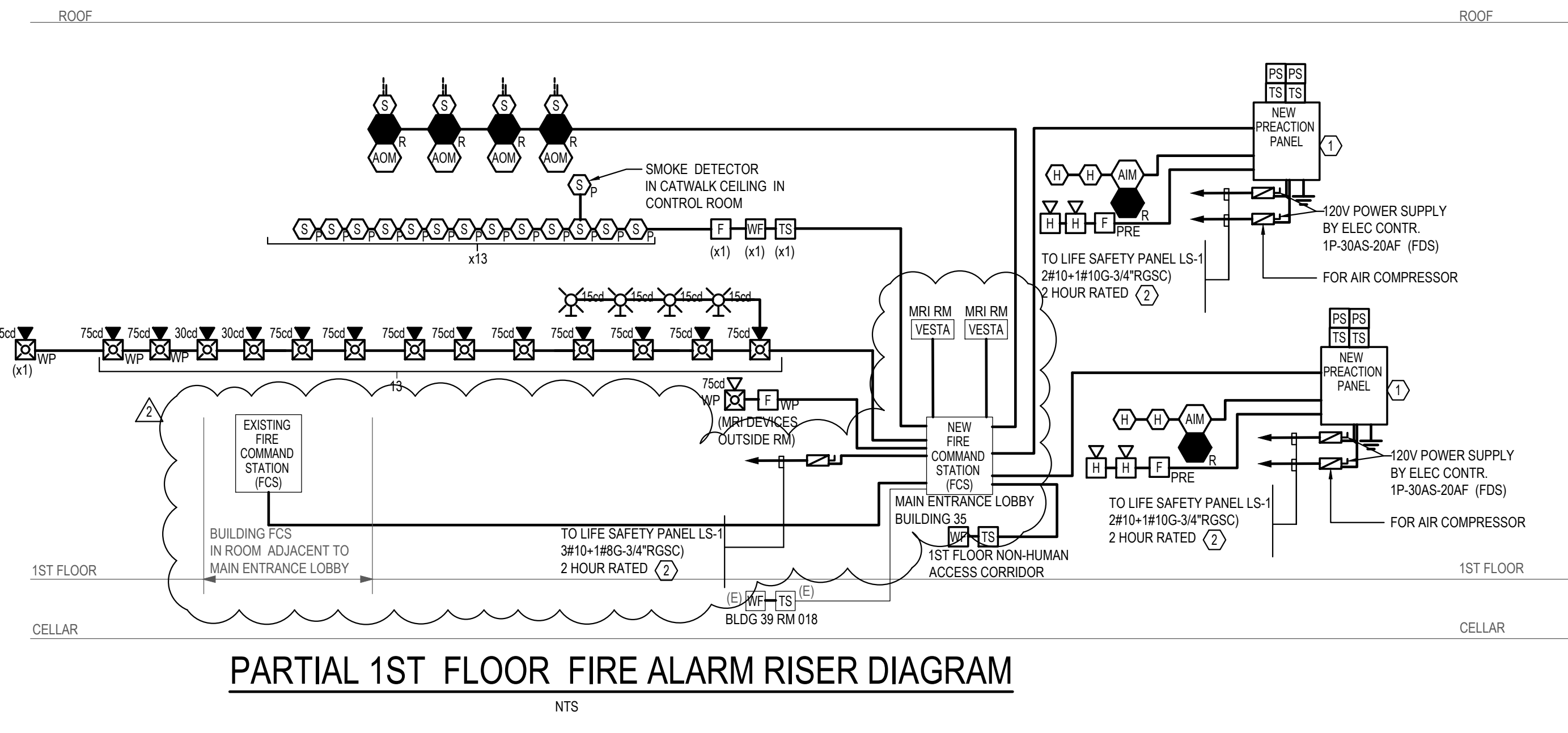

PARTIAL 1ST FLOOR FIRE ALARM RISER DIAGRAM

CONSULTANTS:

CERTIFICATE OF AUTHORIZATION #: 0020083

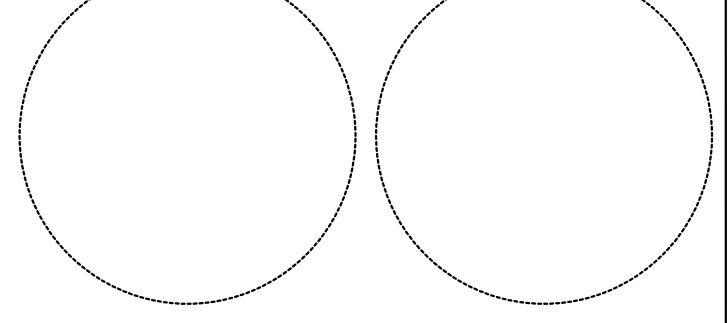

ARCHITECT:
 JACK L. GORDON ARCHITECTS
 MEP/FP/FA/ENGINEER:
 LEGACY ENGINEERS
 SITE/CIVIL ENGINEER:
 HAYDUK ENGINEERING
 GEOTECHNICAL ENGINEER:
 HARTLAND ENGINEERING
 STRUCTURAL ENGINEER:
 YSRAEL A. SEINUK, PC
 IT CONSULTANT:
 CERAMI & ASSOCIATES

ENERGY CODE STATEMENT:
 TO THE BEST OF THE ARCHITECT/ENGINEER'S KNOWLEDGE, BELIEF AND PROFESSIONAL JUDGEMENT, THESE PLANS AND/OR SPECIFICATIONS ARE IN COMPLIANCE WITH THE 2020 NEW YORK STATE ENERGY CODE.
 2020 NEW YORK STATE FIRE CODE AND BUILDING CODE
 1. TO THE BEST OF THE KNOWLEDGE, BELIEF AND PROFESSIONAL JUDGEMENT OF THE LICENSED PROFESSIONAL SEALING THESE PLANS AND SPECIFICATIONS, THESE PLANS ARE IN COMPLIANCE WITH THE 2020 NEW YORK STATE FIRE CODE AND BUILDING CODE.

WARNING:
 THE ALTERATION OF THIS MATERIAL IN ANY WAY, UNLESS DONE UNDER THE DIRECTION OF A COMPARABLE PROFESSIONAL, I.E. ARCHITECT FOR AN ARCHITECT, ENGINEER FOR AN ENGINEER OR LANDSCAPE ARCHITECT FOR A LANDSCAPE ARCHITECT, IS A VIOLATION OF THE NEW YORK STATE EDUCATION LAW AND/OR REGULATIONS AND IS A CLASS "A" MISDEMEANOR.

REGISTRATION EXPIRES:

CONTRACT: FIRE ALARM

TITLE:
 PROVIDE IMAGING BAY,
 BUILDING 35

LOCATION:
 NATHAN KLINE RESEARCH INSTITUTE
 140 OLD ORANGEBURG RD.
 ORANGEBURG, NY

CLIENT:
 NEW YORK STATE
 OFFICE OF MENTAL HEALTH

	05/18/2025	BID DOCUMENT
⚠	11/11/2025	REVISED DRAWING

MARK	DATE	DESCRIPTION

PROJECT NUMBER: 46218-FA
 DESIGNED BY:
 DRAWN BY: LE
 FIELD CHECK:

APPROVED: LE

SHEET TITLE:
 FIRE ALARM COMMON SHEET

DRAWING NUMBER:
 FA-300